

# 4BR



**EVERYTHING YOU NEED, AND MORE 262 SQM (Net)**

With triple exposure (north, east, and south), a massive living room and dining area with large terrace, outstanding dry and wet kitchen space, this home is just perfect for families and tenants with an active social life, needing extra space to host private parties and events.

6 x 5 x 1 x 4 + 1 x 4 x

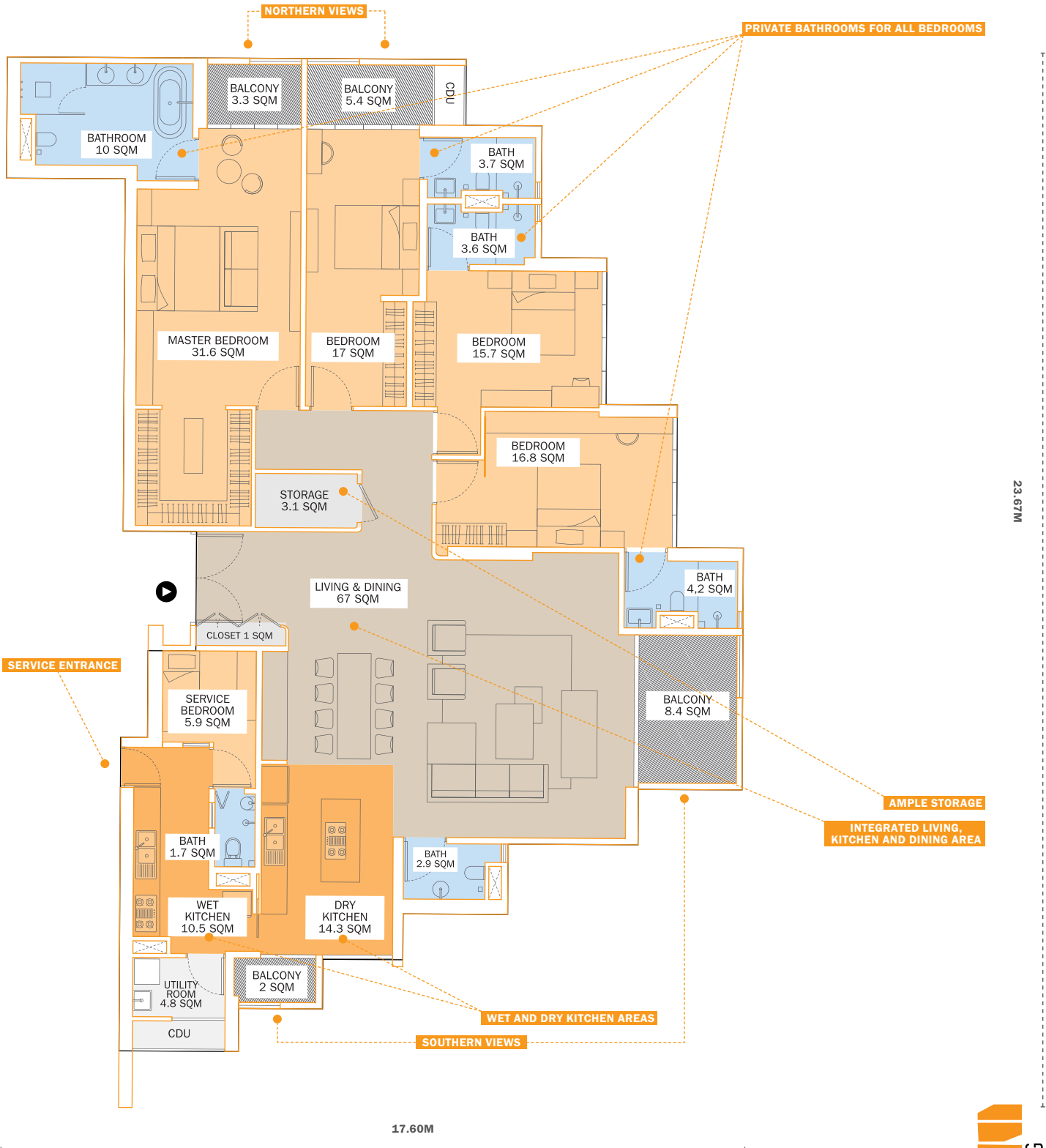

**Net SQM Calculation** Net calculation is based on the perimeter red line as indicated. **Room Areas** Measurements for rooms are approximate only and calculated based on expected usable space, excluding walls and extrusions. Room spaces will total less than the total NET space. Please refer to dimensions or drawings provided for the unit with the SPA. **Variance** These drawings represent conceptual layout before final engineering stage and are subject to change based on regulatory or technical requirements.

# 4BR

EVERYTHING YOU NEED, AND MORE 262 SQM (Net)



## AMENITIES

### EQUIPPED KITCHEN\*

- Wet and dry kitchens
- Top of the line cabinets
- Stovetop
- Oven
- Electric hood
- Wine fridge
- Dishwasher
- Microwave

\*Refrigerator not included

### AMPLE BATHROOMS

- Master bath with bathtub, and dual sinks
- Powder room
- Vanity
- Rain shower in main bathrooms

### COMFORTS THROUGHOUT THE HOME

- 4 balconies
- Master bedroom with en suite bathrooms
- Energy-efficient AC units in living areas and bedrooms
- Parquet flooring in bedrooms, Living and Dining areas
- Beautifully tiled floors in Kitchen areas
- Ceiling fans
- Service quarter
- Large closets



SPACIOUS LIVING AREA WITH VIEWS OF THE MEKONG IS SURE TO IMPRESS



VIEW OF THE BATHROOM WITH BATHTUB & DUAL SINKS